

Without vertical jackscrews  
 Color RAL 5009  
 Painting plan 203A  
 Mounting NEMA F-1  
 Mounting B34R(D)

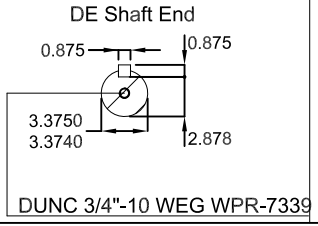

DUNC 3/4"-10 WEG WPR-7339

250 HP 04 Poles 60 Hz A

|           |            |     |                                     |          |            |          |
|-----------|------------|-----|-------------------------------------|----------|------------|----------|
| ECM       |            | LOC | SUMMARY OF MODIFICATIONS            |          | HYBRISUSER | 00       |
| EXECUTED  | HYBRISUSER |     | THREE PH. MOTOR W22 NEMA PREM. EFF. | EXECUTED | CHECKED    | RELEASED |
| CHECKED   |            |     | FRAME 445/7TC IP55 TEFC             |          |            |          |
| RELEASED  |            |     |                                     |          |            |          |
| REL. DATE |            |     |                                     |          |            |          |

PREVIEW  
 WDD 00  
 SHEET /